

PRINTABLE INFO SHEET

Series: Beacon

Model: DD137A PRIME



About This Model

Style: Single / Bedrooms: 3 / Bathrooms: 2 / Square Feet: 1140

CUSTOMER CONTACT

Notes:

PRINTABLE INFO SHEET

Series: Beacon
 Model: DD137A PRIME



Floorplan

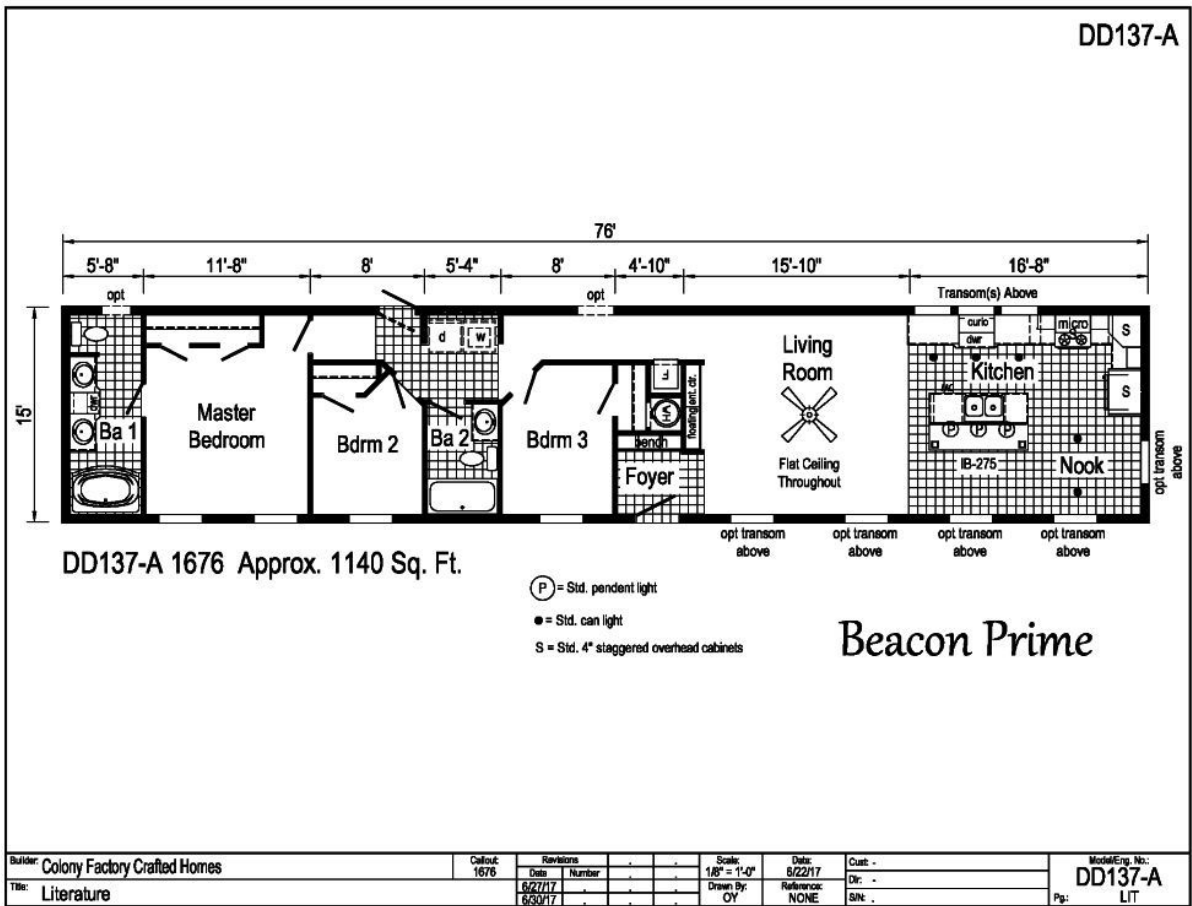

CUSTOMER CONTACT

Notes:

PRINTABLE INFO SHEET

Series: Beacon
Model: DD137A PRIME



Standards & Features

Interior

Stipple Ceiling
Vaulted Ceiling Throughout
7'0" Sidewall Height

Vinyl Wall Covering on Gypsum

Rebond Carpet Pad

Vinyl Flooring per Model

Metal Interior Passage Sets
Pre-Hung Door Jambs
Mortise Hinges
Floor Mount Door Stops
Smoke Detectors with Battery Back-Up
White 6-Panel Interior Doors

Kitchen

Choice of Autumn or Messina Oak Cabinetry
Lined Overhead Cabinets
MDF Raised Panel Cabinet Doors
Base Shelf in Kitchen Base Cabinets
Deluxe Roller Drawer Guides
Brushed Nickel Cabinet Hardware
Hidden Hinges on Cabinets

Laminate Countertops with Laminate Edging

Stainless Steel Sink
Utopia Chrome Faucet
1 USB Receptacle

Appliances

30" Gas Range
Power Range Hood with Light
18 Cu.Ft. No-Frost Refrigerator

Baths

60" Tub/Shower

Baths (continued)

Shower Drain with Removable Strainer
1.6 Gallon Per Flush Toilets

Laminate Countertops with Laminate Edging

Lighted Vent Fan in Each Bath
Brushed Nickel Cabinet Hardware
Base Shelf in Vanities
33" High Bath Vanities
Anti-Scald Faucets in Tub/Shower

Bedrooms

Switched Receptacles
Egress Window in Each Bedroom
Wire Shelving in Wardrobes

Utilities

Plumb for Washer
Wire and Vent for Electric Dryer
100 AMP Electrical Service
30 Gallon Electric Water Heater
Gas Furnace with Air Exchanger
Aluminum Heat Ducts
Copper Wiring Throughout
Main Water Line Shut-Off Valve
Air Conditioning Ready Thermostat with 5-Wires

Insulation

R-14 Fiberglass Insulation in Floor
R-19 Fiberglass Insulation in Walls
R-25 Avg. Blown Insulation in Ceiling Singles Section Homes
R-28 Avg. Blown Insulation in Ceiling Ranch Homes

Exterior

White Coach Light at Front Door

CUSTOMER CONTACT

Notes:

PRINTABLE INFO SHEET

Series: Beacon

Model: DD137A PRIME



Standards & Features (continued)

Vinyl Exterior Siding with Sheathing Board

One GFI-Protected Exterior Receptacle

Shingle Roof with Vented Soffits and Ridge Vent

34x76 House-Type Front Door with Storm

Vinyl Windows

12" Louvered Shutters on Front Door Side & 28 wides

12" Louvered Shutters on Front and Front Door Side &

14/16 wides

Construction

Transverse Floor System:

2x6 on 14" & 28" Wide Models

2x8 on 16" Wide Models

2x6 Exterior Walls on 16" Centers**

20# Roof Load

3/4" T&G OSB Floor Decking

**NOTE: Spacing for Framing Members may vary due to

Design Requirements

CUSTOMER CONTACT

Notes:
